

**BEFORE RETURNING THIS PRODUCT TO THE STORE** for any reason, please call ARRIS Technical Support for assistance: **1-877-466-8646**. Please visit [www.arris.com/selfhelp](http://www.arris.com/selfhelp) for frequently asked questions (FAQs), product manuals, Live Chat and Software License and Warranty information.

Place the Product specific  
label here

© 2021 CommScope, Inc. All rights reserved.

ARRIS and the ARRIS Logo are trademarks of CommScope, Inc. and/or its affiliates. All other trademarks are the property of their respective owners.

No part of this content may be reproduced in any form or by any means or used to make any derivative work (such as translation, transformation, or adaptation) without written permission from CommScope, Inc. and/or its affiliates ("CommScope"). CommScope reserves the right to revise or change this content from time to time without obligation on the part of CommScope to provide notification of such revision or change.

CommScope provides this content without warranty of any kind, implied or expressed, including, but not limited to, the implied warranties of merchantability and fitness for a particular purpose. CommScope may make improvements or changes in the products or services described in this content at any time. The capabilities, system requirements and/or compatibility with third-party products described herein are subject to change without notice.



Part Number ARSVD01808-f



Quick Start Card

**SURFboard™**  
Wi-Fi Cable Modem

[www.arris.com/selfhelp](http://www.arris.com/selfhelp)

# 1

Unbox the device; plug in the power cable (included) and a coax cable (not included).

### SURFboard Wi-Fi cable modem

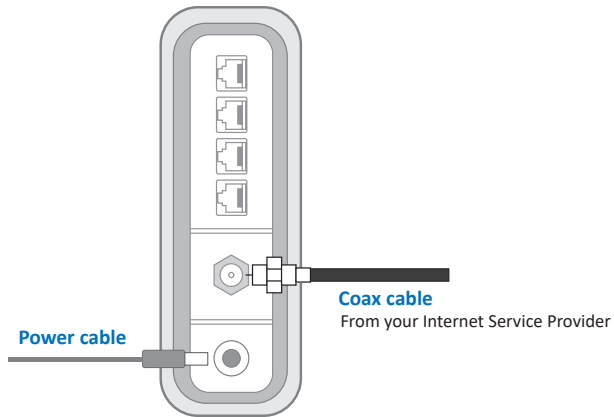

# 2

Download and install the **SURFboard Central** mobile app to set up and manage your device.

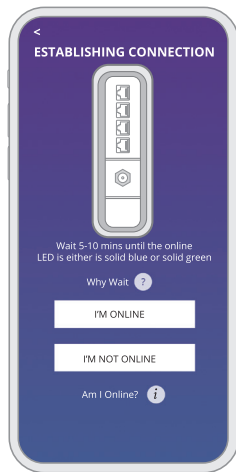

Scan to download the mobile app

With the mobile app, you get:

- Step-by-step installation instructions
- Activation support for your specific service provider
- Automatic device registration for warranty
- Management of your home Wi-Fi network
- Product documentation, Tech Support, and FAQs.
- Software License and Warranty information

**Using Web Interface:** After product activation, access your device by connecting an Ethernet cable between your desktop/laptop and your Wi-Fi cable modem and then navigate to **192.168.0.1** in a Web browser.

**Username:** admin (case-sensitive) OR the email address used to set up the mobile app

**Password:** customized during first time web GUI access OR use the password available in the mobile app



SURFboard®  
Central

**Need help?** For product activation support, contact your Internet Service Provider.